

# POC252-1CX-1P

## Extensor Over Coax 1 Porto IP PoE-AT (câmara)

### Overview

The IFS® Power over Coax Network Switches and Media Converters by Interlogix® are designed to transmit both Ethernet data and PoE over coax cable up to 1 km (3,280 ft). This solution provides a cost-effective approach by reducing installation cost and increasing ROI by utilizing existing coax to migrate an existing analog video system to an IP video surveillance system.

The PoC Network Switches and Media Converters also provide built-in PD-alive monitor health and status of an IP camera. In addition, this solution eliminates the need for providing local power at an IP PoE camera location.

- The POC2502-8CXP-2T-2S is an 8-port Power over Coax Managed Switch that supplies data and power transmission on coax via BNC ports. In addition, the two RJ45/SFP Gigabit combo ports provide a connection to an Ethernet network.

- The POC2502-16CXP-2T-2S is a 16-port Power over Coax Managed Switch. The switch supplies data and power transmission on coax via BNC ports as well as two RJ45/SFP Gigabit combo ports for connection to an Ethernet network.

- The POC252-1CX-1P Power over Coax Media Converter is for use at the camera end to convert the data/power from the coax. The switch provides 10/100Mbps data and POE-af/at compliant power on the RJ45 port for an IP camera.

- The POC252-1CXP-1T Power over Coax Media Converter transmits data and injects power over coax for use with the POC252-1CX-1P. This is used to deploy a single IP camera on a length of coax cable and a multi-port BNC switch is not needed.



### Detalhes

- 1 Port (RJ45) with PoE-at support (upto Max. 25W)
- Auto-negotiation and auto-MDI/MDI-X
- IEEE 1901 communication Standard
- Wavelet-OFDM modulation
- 128-bit AES security encryption
- Daisy-chain (up to 3 devices on one link)
- Half-duplex back pressure and IEEE802.3x full-duplex pause-frame flow control
- Remote power up to 1Km
- Compatible with POC252 Switches and Head End Media Converter

# POC252-1CX-1P

## Extensor Over Coax 1 Porto IP PoE-AT (câmara)

### Especificações técnicas

Geral	
Tecnologia	IEEE1901
Compatível com rack MCR	Não

Conexões	
Portas coaxiais	1
Conetor	BNC
Portos RJ45	1
Tipo de porto	10/100
Saída Falha por relé	Não

Elétrica	
Tipo de fonte de alimentação	Via Power Over Coax
Consumo de energia	25 W
PoE / PoE+	PoE-at
Potência Total PoE Disponível	Up to 25 W
Fonte redundante	Não

Físico	
Dimensões físicas	94 x 70 x 26 mm
Peso líquido	375 g
Cor	Preto
Tipo de montagem	Montagem em parede

Ambiental	
Temperatura de operação	-10 to +60°C
Temperatura de armazenamento	-40 to 75°C
Humidade relativa	0 to 95% noncondensing

Physical Ports	
10/100Base-T(x) Ports	RJ-45 (1) & BNC (1)
Port Configuration	Auto MDI/MDI-X
Port Speed	Auto-negotiate
LED Indicators and Switch	

Regulatory	
Regulatory Standards	FCC Part 15 Class A, CE
IEEE Standards	IEEE 802.3 Ethernet IEEE 802.3u Fast Ethernet IEEE 802.3af Power over Ethernet IEEE 802.3at Power over Ethernet Plus

Power over Ethernet	
PoE Standard	IEEE 802.3af / 802.3at PoE
PoE Power Supply Type	End-span
PoE Power Budget	Upto 25W via Coax
Power Pin Assignment (RJ45)	1/2(+), 3/6(-)
Power Pin Assignment (COAX)	BNC center pole : DC+ / Hi, BNC shield : DC - / Lo

IP Over Coax Interface	
Cabling	Coaxial cable: 75 ohm, RG-6/U cable (Improved Performance) RG-6/U cable, less than 120hm/1,000ft. RG59/U cable, less than 300hm/1,000ft.
Ethernet Communication Standard	IEEE1901
Modulation Type	Wavelet-OFDM
Security	128-bit AES encryption
Frequency Band	2 ~ 28 MHz

Data Rate (Upload/Download)*	
200m	93 / 93 Mbps
400m	93 / 92 Mbps
600m	92 / 88 Mbps
800m	83 / 75 Mbps
1000m	74 / 55 Mbps

Typical Power Over Coax*	
200m	29W (56VDC in) 16.9W (PoE+ in)
400m	22W (56VDC in) 14.3W (PoE+ in)
600m	13W (56VDC in) 10.2W (PoE+ in)
800m	10W (56VDC in) 8.3W (PoE+ in)
1000m	8W (56VDC in) 7.1W (PoE+ in)

\* Based on RG-59 Bare Copper cable: Data rate and power performance is subject to the quality of cable used and environmental factors.

Maximum Distance	
PoE+ output	200m
PoE output	600m
Without PoE (Data only)	1,200m

# POC252-1CX-1P

## Extensor Over Coax 1 Porto IP PoE-AT (câmara)

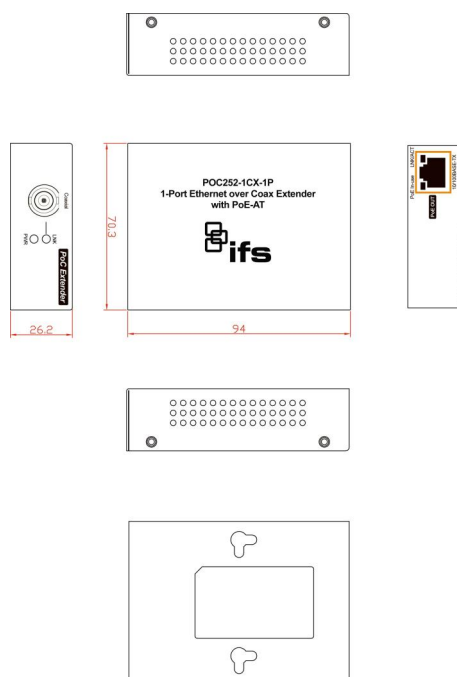

Como empresa de inovação, a Carrier Fire & Security reserva o direito de alterar as especificações do produto sem aviso prévio. Para obter informações sobre as especificações mais recentes do produto, visite [pt.firesecurityproducts.com](http://pt.firesecurityproducts.com) online ou contate o departamento comercial.

Last updated on 22 May 2023 - 16:24