

KIDDE

COMMERCIAL

Kidde Commercial 2X-A, 2X-AT and Excellence Series

SETTING THE NEW STANDARD
IN FIRE DETECTION



“Intuitive set up and operation. Intelligent smoke and heat discrimination and IP connectivity to mobile devices and CMS ensure that smoke is detected and notified early, saving property & lives.”

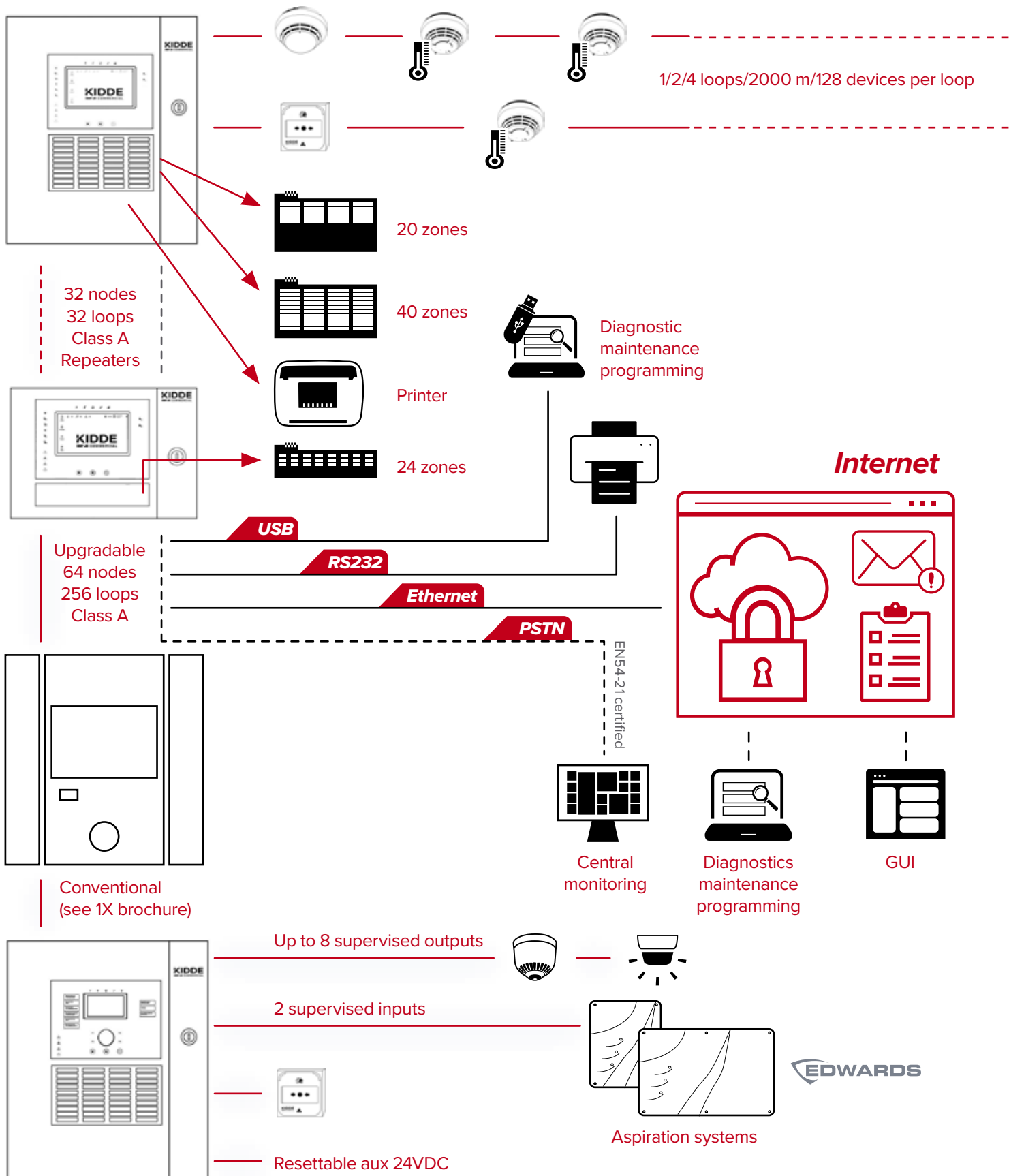

**Easy remote access
over Ethernet**

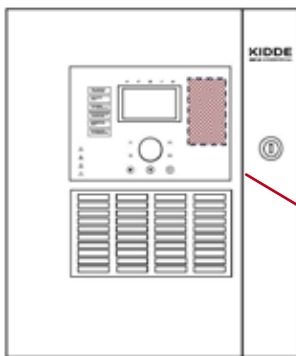
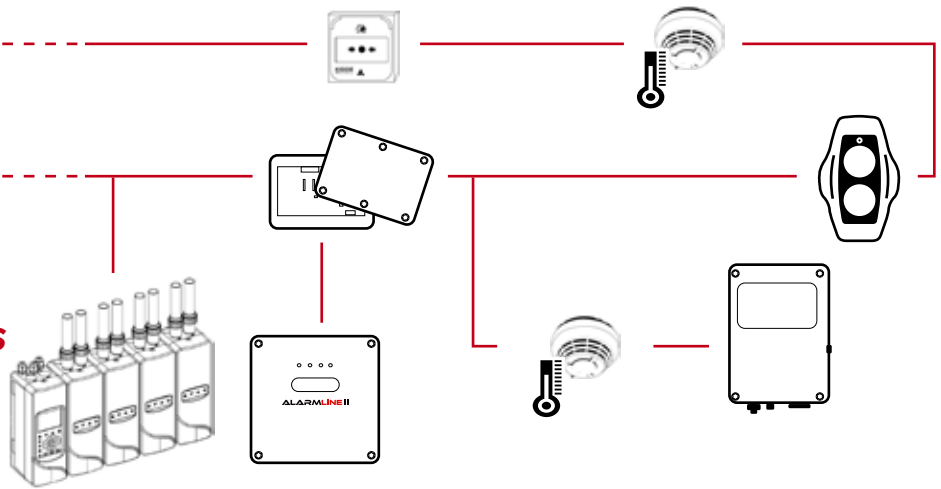

7 zones
manual
evacuation



Scandinavian
key lock

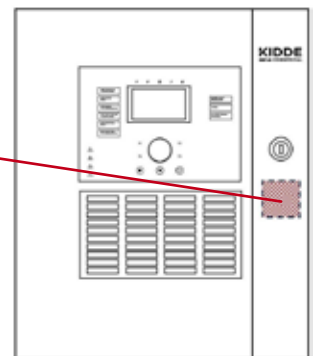

“Intuitive set up and operation. Intelligent smoke discrimination and IP connectivity to mobile devices and CMS ensure that smoke is detected and notified early, saving property & lives.”

The installer's best friend

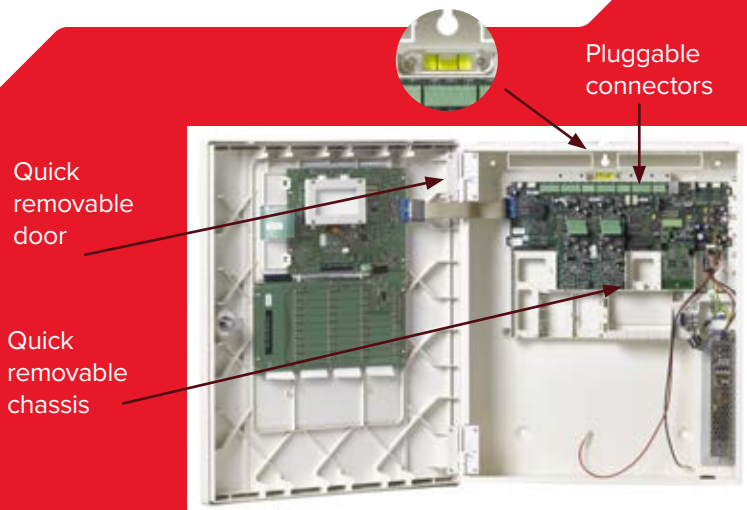

- Fire panels
- Repeaters
- Evacuation
- EXCELLENCE SERIES Intelligent devices



“Unsurpassed performance for standalone up to small/medium size networked applications.”

Stylishly effective:

- **Cost Effective Installation**
 - 4 High Power Loops (800ma per loop) allows 3.2 times more devices to be fitted to system
- **Cost Effective Commissioning**
 - New intelligent devices are quicker to commission and maintain
 - New migration tools greatly reduce time to upgrade protocols
 - Panels can assist configuration when new devices are added to the system so that old settings are not lost
- **Cost Effective Operation**
 - New intuitive touch screen increases the speed of operation by three times
 - New smoke discrimination algorithm ensures the more accurate detection of smoke, reducing false alarms
 - Due to all innovations, product life cost reduced by 16%
- **Cost Effective Maintenance**
 - IP connectivity and remote control of panel via PCC allows remote diagnostics, reducing travel to site
- **Reduced Losses and Casualties**
 - Kidde Commercial panels, with the new intelligent detectors that give more accurate detection of smoke, reduce false alarms and integrate with other systems (e.g. PAVA systems) to minimise the threat to property and personell
- **Expandable and Upgradeable System As Schedules Allow**
 - Panel is both backward compatible and future proof, and can integrate with aspiration, conventional and wireless systems
- **Always Secure**
 - 72-hour system coverage, on power failure, ensuring unmanned property is fully protected over a weekend
- **Always in Touch**
 - With IP connectivity, panel communicates both to mobile devices and CMS, ensuring faults and emergencies are picked up immediately
- **Place Anywhere Panel**
 - Reinforced design with metal door and improved aesthetics; increases mounting options, including in public areas