

Why is moving from ATS125x series to CDC4 door controller a logical step?

Secure and configurable bus structure allowing integration of locks, readers and cards

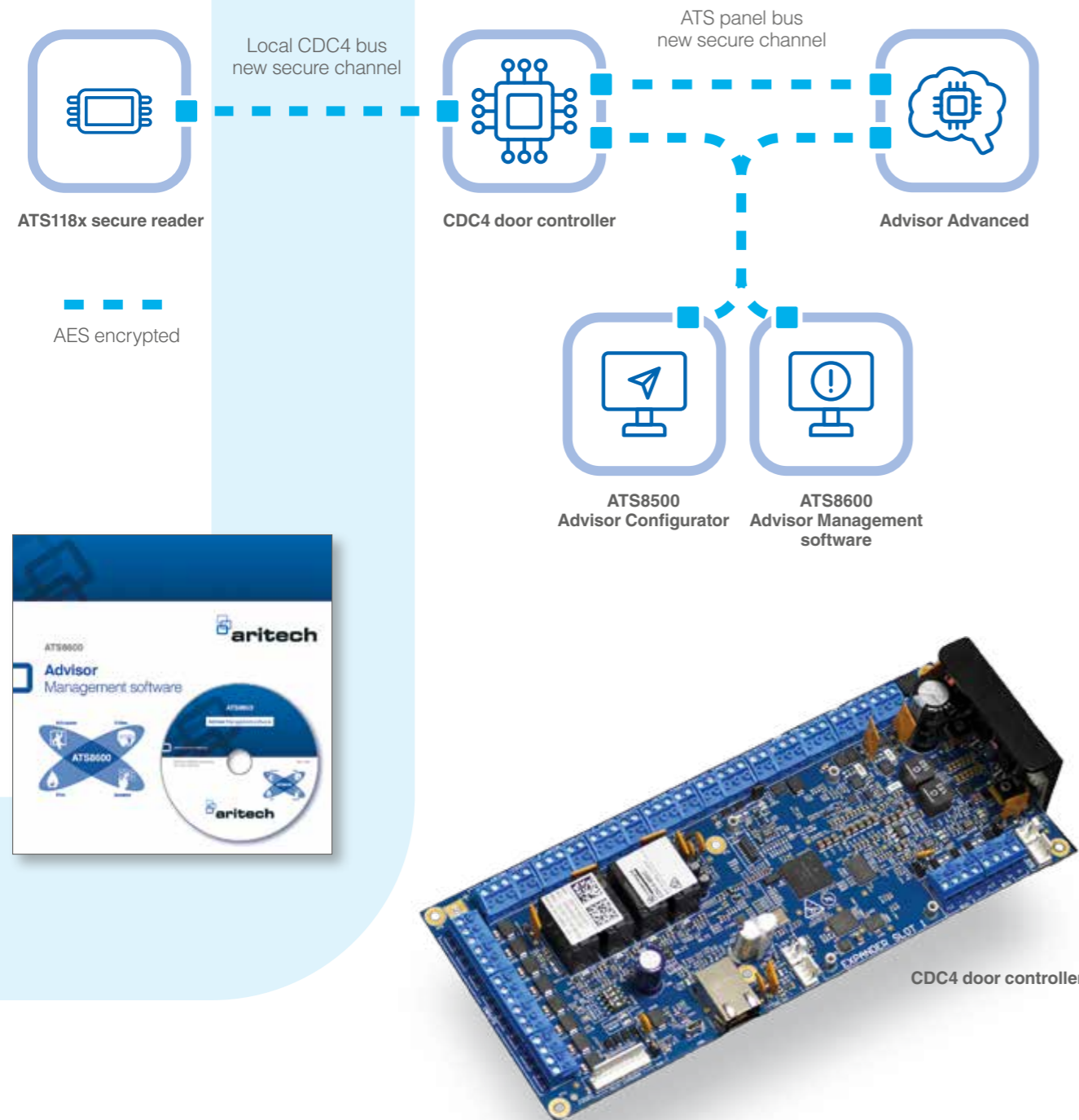

Providing your customers with a more efficient, more secure and more flexible solution.

ATS125x series

CDC4 door controller

Hardware	ATS125x series	CDC4 door controller
SKU: ATS1250,ATS1251,ATS1252,ATS1253, ATS1254	No IP nor USB onboard	SKU: CDC4
One RS485-bus connection, ATS readers only	Memory expansion required when needing more than 2000 users	Onboard USB & IP, providing immediate access to the status of the doors, locks, and the system
Limited diagnostics	ATS125x series does not provide extension capabilities	Has two RS485 connections, both configurable, with selectable protocol, one of which allows to connect to wireless devices
		No memory expansion required for users, schedules, credentials, etc.
		Up to 32 readers and 30 expanders
		Full diagnostics
		Portfolio will soon be extended with CDC-2DWIF, a Dual Wiegand Interface with 4 inputs

Firmware	ATS125x series	CDC4 door controller
Only one mode	Real time alarm & access control for up to 4 intelligent doors per controller	Standard (legacy) mode of operation and Extended mode of operation, allowing to address larger applications
Max. 48 intelligent doors/panel	Max. 32 inputs available and 16 outputs	Real time alarm & access control for up to 8 doors per controller (extended mode)
Reader address sets reader configuration, max. 4 per door	No security between reader and controller or controller and intrusion panel.	Up to 96 intelligent doors (extended mode)
No OSDP support (Open Supervised Device Protocol)	No wireless locks support	Any input (max. 32) and output (max. 16) can be assigned to report to control panel
No OSDP support (Open Supervised Device Protocol)	Transfer of users is slow (all users coming from intrusion panel) compared to CDC4	Any reader can be assigned to any door (up to 6 per door)
		Any reader can be at any door side
		Secure communication from card to reader to controller using ATS118x series secure readers
		OSDP V2 support, improving interoperability among access control and security products
		Supporting Wireless Aperio locks (using AH30), providing you with the freedom to implement new business ideas
		Wireless Salto XS4 locks through Sallis Router 485 offering more real-time access control options
		Credentials programmable through management software allowing quick user and credential download

No unlock by card (except using macro's and area)	Auto arming when last user leaves (requires in/out reader)	Some new capabilities
Lock configuration with different settings	New 3 x # option to arm area with PIN	
Limited extended unlock features	New option to unlock when disarmed / lock when armed	
No timed anti-passback	New option to use low security mode when disarmed	
	Scheduled actions for lock/unlock/enable/disable	
	Simplified lock configuration	
	Extended unlock features to support disabled persons	
	Two badge unlock, 1 badge lock option	
	Timed anti-passback transfer	

